



# E - HOUSE



## E-House / PEECC

Powergear designed E-house is a fabricated metal enclosed electrical room manufactured at our plant in Chennai and transported to the site. These walk-in enclosures are insulated with a HVAC system and are usually installed outdoors. A typical E-house consists of various kinds of Electrical Equipment with interconnecting wires installed in the floor or in the roof.

### Advantages of E-house

- Quick Installation and Start-up time at project site
- Wide range of parameters pre tested in factory
- Avoidance of possible mistakes in wiring at site
- Mobility of entire E-house provides easy relocation
- Can be expanded
- Least Erection & Commissioning time

### Powergear Advantage

- Custom made with in-house design capabilities
- Vertically integrated manufacturing set-up
- Capability to design electrical panels used in E-house
- Exposure to various country specific standards

### Powergear's E-house Features

- Enclosure are designed for IP54, IP55 or IP56 ratings
- CE compliance or any specific compliances can be adhered to
- Painting system with highest corrosion protection
- Acid resistant painting for battery compartment
- Raised floor for interconnect wiring
- Internal lighting and sockets provided
- Smoke detection and Fire protection

### Facilities

- Capability to manufacture large number of E-houses at a time
- Fully integrated design, fabrication, painting, assembly and testing facilities available in-house
- Proximity to major sea port
- High Voltage testing laboratory available in-house



Rainwater testing under progress



Suitable HVAC systems are designed and procured by in-house team

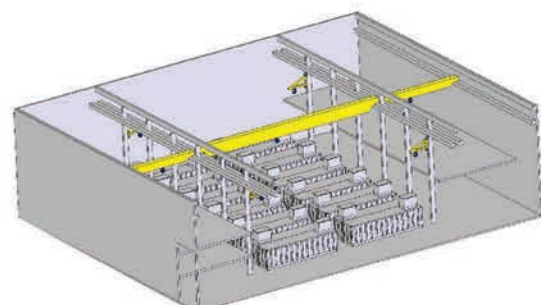



**Powergear offers Motor Control Centers which can be installed in the E-House.**

### **Motor Control Center**

Powergear MCC is the result of over 35 years of experience in design, manufacture and application of Low Voltage Motor Control Center. Our design incorporates fully isolated enclosures which provide maximum fault containment and prevent a single fault from cascading throughout the enclosure thus limiting equipment damage. Our MCCs are designed to address the causes of arc flash and other electrical safety hazards such as shock and electrocution.

### **Standards**

The Powergear-MCC is designed, verified and constructed in accordance with the following industry standards and guidelines: IEC 61439 & IEEE C37.20.1

### **MCC GENERAL ARRANGEMENT**



## Product Description as Per Customer Requirement

### Electrical Ratings

- Available nominal operating voltages: 400VAC, 415VAC, 480VAC, 600VAC
- Available power system types: 3 phase, 3 wire; 3 phase, 4 wire
- Frequency: 50/60 Hz
- Short circuit current withstand: 50kA, 65kA

### Continuous Current Ratings

- Horizontal main bus: 1600A, 2000A, 2500A, 3000A
- Vertical distribution bus: 800A
- Neutral bus (horizontal): 800A, 1200A, 1600A
- Neutral bus (vertical): 600A, 800A

### Product Advantages

- Rugged and reliable
- Reduced time needed for installation and start-up
- Space saving design
- No tools required for module removal
- Simplicity in adding special components
- Ease of future modifications

### Other Names Used

1. PEECC, 2. E-Room, 3. Power Control Cubicle,
4. Electrical House.

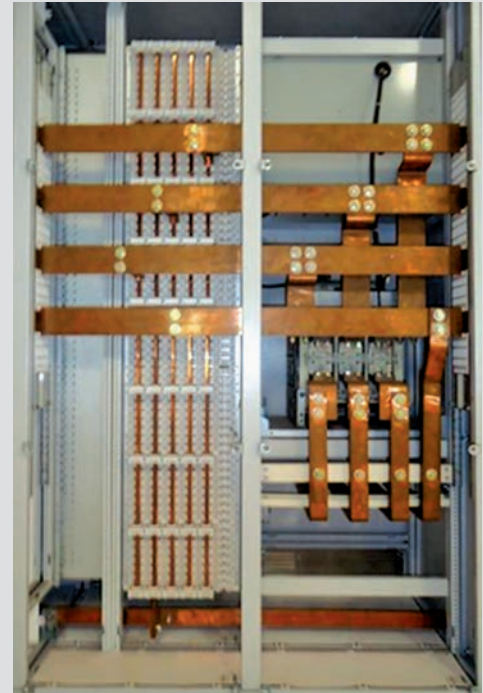

**POWER BUS BAR ARRANGEMENT**

## ABOUT POWERGEAR

The group has been in the field of design, manufacturing and erection of high current busduct, specialized switchgear and control panels. With certifications like ISO 9001, ISO 14001, OHSAS 18001, AWS and many awards for excellence in product quality, fulfillment and long term association with many global giants, it is natural that best products and services are assured. Powergear products are in operation in more than 50 countries across the world.



Scan this QR code with your smart phone  
for a direct link to our website.

## Powergear Limited

Plot No – B-33 , Phase II, 5th Main Road , SEZ-MEPZ  
Tambaram, Chennai – 600045, INDIA

Tel : +91 44 42901111

Fax: +91 44 22624434

Email: [enquiries@powergearlimited.com](mailto:enquiries@powergearlimited.com),

[www.powergearlimited.com](http://www.powergearlimited.com)